

G9-LED

Fig. similar

basket

Safety instructions: All electrical work (work on electrical equipment and installations) must be carried out and checked by a qualified electrician or under their direction and supervision.

Always disconnect from the mains! Use your lamp only in normally tempered, dry indoor rooms or in suitable luminaires for outdoor use.



Screw the ceramic adapter into the socket and insert the lamp. Then screw on the shade basket, done - your luminaire is now ready for use.

Your lamp is now ready for use.

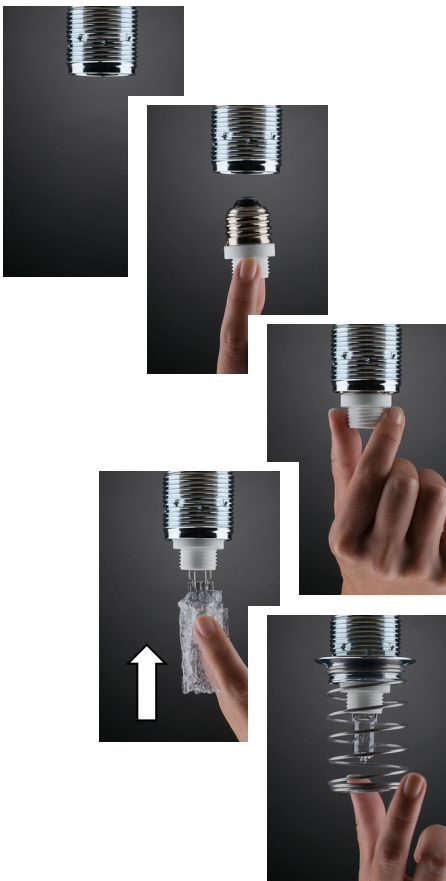

Changing G9 bulbs

Attention, important note: For all work on the lamp, always disconnect it from the mains first!

- Unscrew the shade basket and replace the bulb.
- Only use light sources of the same wattage as specified on the type plate.



Safety instructions: All electrical work (work on electrical equipment and installations) must be carried out and checked by a qualified electrician or under their direction and supervision.

Always disconnect from the mains!

In case of premature failure or non-function of the lamp, please test with a continuity tester whether there is continuity to the G9 socket. Experience shows that the G9 socket sometimes has no contact or the contact is insufficient. In this case, please unscrew the G9 socket.

Bend / press the centre contact or side contact slightly towards the bulb using an insulated electric screwdriver.

(Ensure that there is no voltage ensure safety)
Mount again!

Why G9 bulbs:

- The G9 light source:
 - ecological - high electricity savings compared to conventional incandescent- and halogen lamps
 - small design, little waste
 - free of mercury
 - long burning time

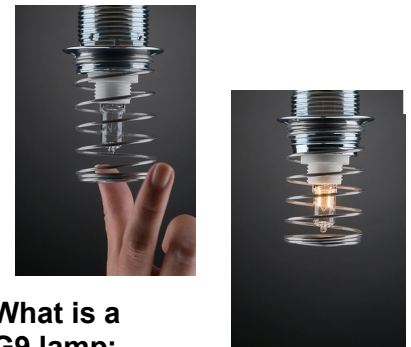
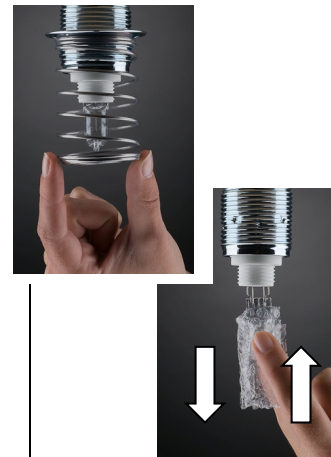

What is a G9 lamp:

The G9 lamps have a plug-in base for 230 Volt mains voltage with 9 mm contact spacing.
G9 IEC 60061-1 (7004-129) 9.0 mm